

## LIQUID COOLED COLD PLATES

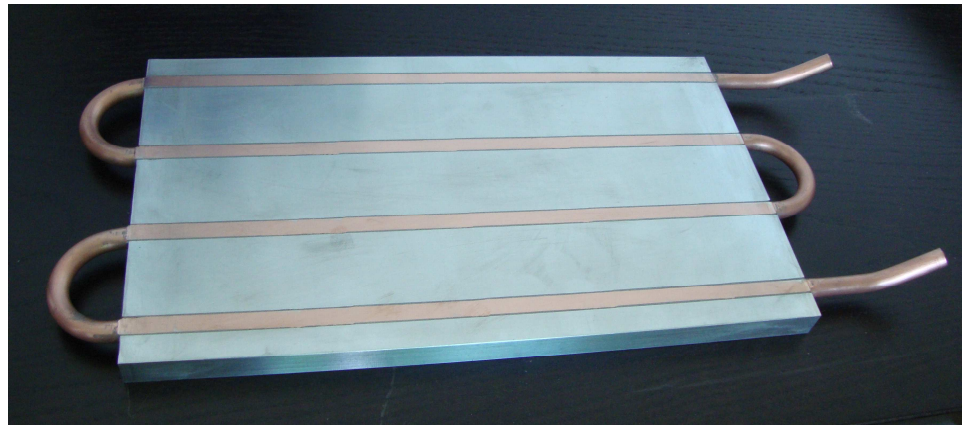

### Why do we need to use cold plates:

When the heat density generated by power devices is so high that it can not be cooled even with the use of forced circulation of air using either bonded fin or folded fin products, one of the most suitable choice is to use liquid cooled cold plate

### Specification Features and Benefits

#### Advantage of SNS Cooling Cold Plates:

1. Extruded base for large qty requirement thus better price & performance.
2. Leak free features on contact surfaces (pressure tested 100% before shipping)
3. Device to be cooled is in direct contact with copper tube. Micro porosity between tube & base plate is filled with thermally conductive aluminum filled epoxy & thus better performance because of no air pockets.
4. Flatness of max 0.002 T.I.R. over surface area of 6"x6 thus thinner layer of thermal grease between device & cold plate.

#### Tube materials offered:

1. Copper
2. Stainless steel
3. Cold drawn aluminum tube
4. 90/10 Cupro-Nickel

#### Tube sizes offered:

: Diameter 1/4", 3/8", 1/2" & 5/8"

#### Tube wall thickness:

: 0.032" to 0.062"

SNS COOLING  
TECHNOLOGY INC  
ISO 9001-2008 CERTIFIED

#### \*\*MANUFACTURING FACILITY

#### LOCATION IN NORTH AMERICA

90-6 MELFORD DRIVE

SCARBROUGH-M1B2A1

ONTARIO CANADA

Email: sales@snscoolingtech.com

#### \*\*SALES OFFICE IN INDIA

C/O MS ACADEMY

MUKTAI NAGAR-AMBEJOGAI

ROAD-LATUR-413513

MAHARASHTRA-INDIA

Email: sales.in@snscoolingtech.com

FOR MORE INFORMATION  
VISIT OUR WEBSITE

WWW.SNSCOOLINGTECH.COM

OR

CALL 416-738-7797 FOR  
IMMEDIATE HELP

## Specification Features

**Base plate material Offered:**  
: 6061-T651 as per AMS 4020/  
ASTM B 209 and 6063-T5

**Surface finish offered:**

1. Wash
2. Clear chromate
3. Yellow chromate
4. ROHS chromate
5. Electro less Nickel Plating

**Wall thickness on fly-cut tube:**

Min 0.032" for 0.049 thick tube &  
0.022" for 0.035" wall thick tube.

**Tube inlet/ outlet features for stocked cold plates:**

1. Plain tubes

**Tube Inlet/ Outlet features for custom order:**

1. Bead single or double
2. Soldered threaded adapter male/ female
3. Quick assembly adapter as per ISO/SAE standard

### MECHANICAL FEATURES:

**1 PASS COLD PLATE**

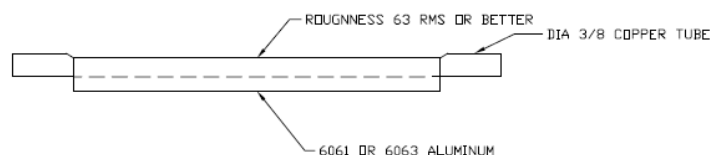
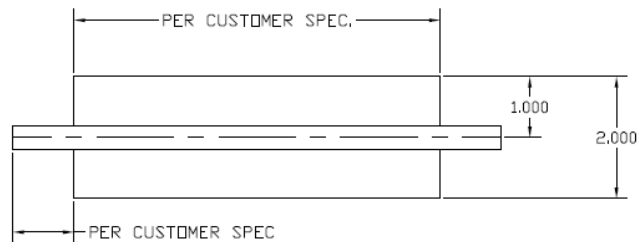

DIMENSIONS AS SHOWN ARE IN INCHES

SNS COOLING  
TECHNOLOGY INC  
ISO 9001-2008 CERTIFIED

**\*\*MANUFACTURING FACILITY**

**LOCATION IN NORTH AMERICA**

90-6 MELFORD DRIVE

SCARBROUGH-M1B2A1

ONTARIO CANADA

Email: sales@snscoolingtech.com

**\*\*SALES OFFICE IN INDIA**

C/O MS ACADEMY

MUKTAI NAGAR-AMBEJOGAI

ROAD-LATUR-413513

MAHARASTHRA-INDIA

Email: sales.in@snscoolingtech.com

FOR MORE INFORMATION  
VISIT OUR WEBSITE

WWW.SNSCOOLINGTECH.COM

OR

CALL 416-738-7797 FOR  
IMMEDIATE HELP

## Specification-Mechanical Features

### 2 PASS COLD PLATE

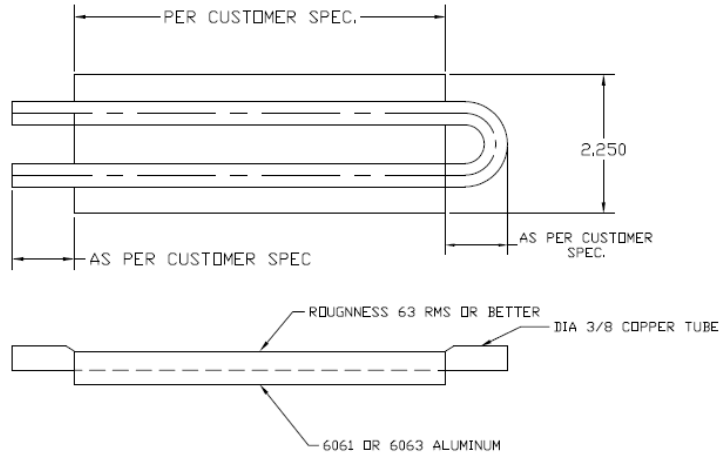

Dimensions as shown are in Inches

### 4 PASS COLD PLATE

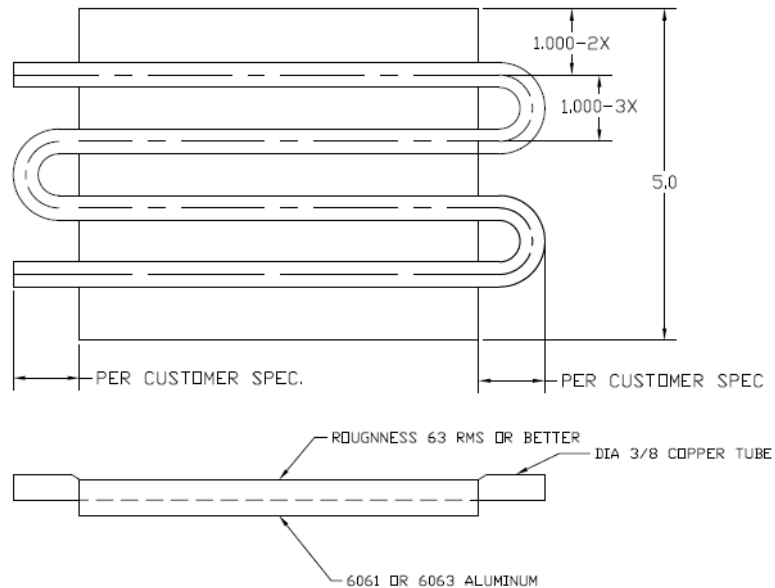

DIMENSIONS AS SHOWN ARE IN INCHES

SNS COOLING  
TECHNOLOGY INC  
ISO 9001-2008 CERTIFIED

**\*\*MANUFACTURING FACILITY**  
LOCATION IN NORTH AMERICA  
90-6 MELFORD DRIVE  
SCARBROUGH-M1B2A1  
ONTARIO CANADA  
Email: sales@snscoolingtech.com

**\*\*SALES OFFICE IN INDIA**  
C/O MS ACADEMY  
MUKTAI NAGAR-AMBEJOGAI  
ROAD-LATUR-413513  
MAHARASTHRA-INDIA  
Email: sales.in@snscoolingtech.com

FOR MORE INFORMATION  
VISIT OUR WEBSITE  
WWW.SNSCOOLINGTECH.COM  
OR  
CALL 416-738-7797 FOR  
IMMEDIATE HELP

## Specification-Mechanical Features

### 6 PASS COLD PLATE

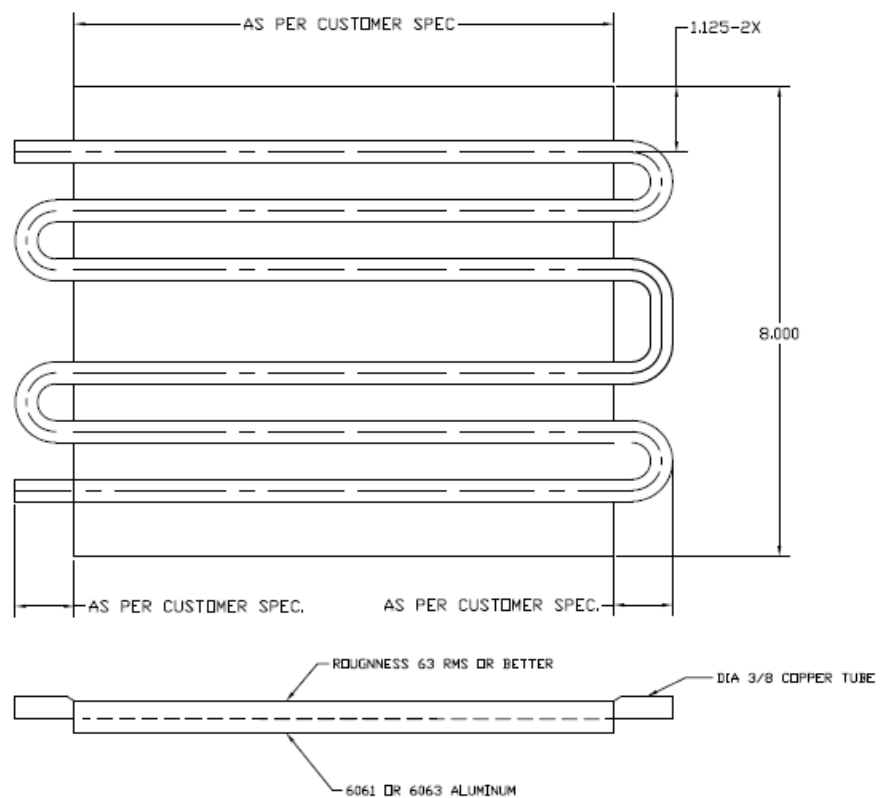

Dimensions as shown are in Inches

### Custom design:

If any of your cooling requirements can not be taken care with existing standard design, then we recommend to send us an email at [sales@snscoolingtech.com](mailto:sales@snscoolingtech.com) so that we can review your requirement & offer our expertise before you finalize the drawing.

SNS COOLING  
TECHNOLOGY INC  
ISO 9001-2008 CERTIFIED

**\*\*MANUFACTURING FACILITY**  
LOCATION IN NORTH AMERICA  
90-6 MELFORD DRIVE  
SCARBROUGH-M1B2A1  
ONTARIO CANADA  
Email: [sales@snscoolingtech.com](mailto:sales@snscoolingtech.com)

**\*\*SALES OFFICE IN INDIA**  
C/O MS ACADEMY  
MUKTAI NAGAR-AMBEJOGAI  
ROAD-LATUR-413513  
MAHARASTHRA-INDIA  
Email: [sales.in@snscoolingtech.com](mailto:sales.in@snscoolingtech.com)

FOR MORE INFORMATION  
VISIT OUR WEBSITE

[WWW.SNSCOOLINGTECH.COM](http://WWW.SNSCOOLINGTECH.COM)

OR

CALL 416-738-7797 FOR  
IMMEDIATE HELP

## STANDARD COLD PLATE ORDERING NUMBER

ITEM#	NUMBER OF PASS	WIDTH (in inches)	LENGTH (in Inches)
92000106	1	2	6
92000112	1	2	12
92000206	2	2.25	6
92000212	2	2.25	12
92000406	4	5	6
92000412	4	5	12
92000606	6	8	6
92000612	6	8	12

**Note:**

1 All standard cold plates are designed with diameter 0.375" copper tube with wall thickness of 0.049" , standard projected length of copper tube beyond the edge of cold plate=2"

2. Pricing for standard cold plates– please visit website.

SNS COOLING  
TECHNOLOGY INC  
ISO 9001-2008 CERTIFIED

**\*\*MANUFACTURING FACILITY**

**LOCATION IN NORTH AMERICA**

90-6 MELFORD DRIVE  
SCARBROUGH-M1B2A1  
ONTARIO CANADA  
Email: sales@snscoolingtech.com

**\*\*SALES OFFICE IN INDIA**

C/O MS ACADEMY  
MUKTAI NAGAR-AMBEJOGAI  
ROAD-LATUR-413513  
MAHARASTHRA-INDIA  
Email: sales.in@snscoolingtech.com

FOR MORE INFORMATION  
VISIT OUR WEBSITE

WWW.SNSCOOLINGTECH.COM

OR

CALL 416-738-7797 FOR  
IMMEDIATE HELP